

PLATON SERVICE
 8 (800) 500-34-41
 www.platonservice.com

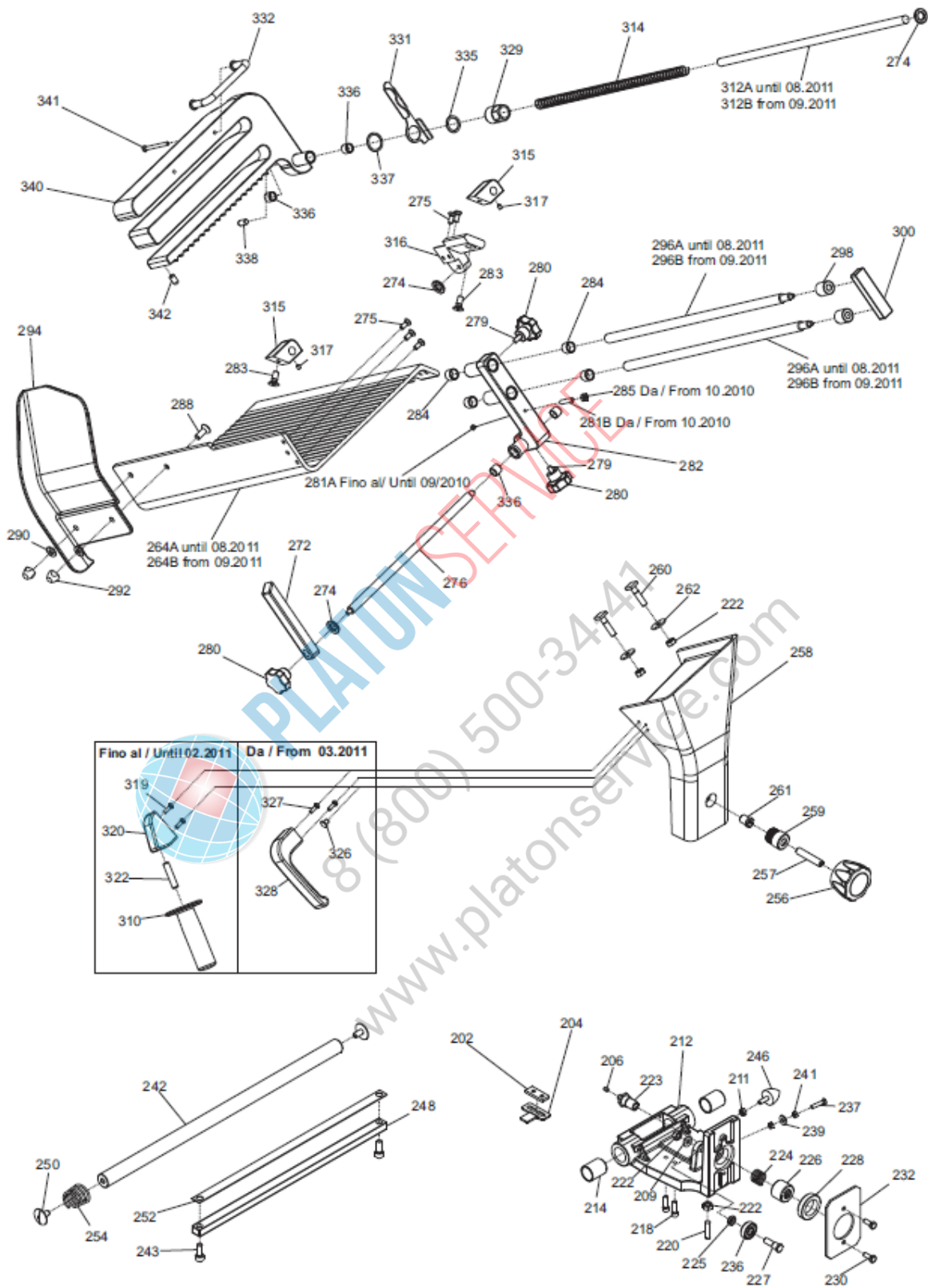

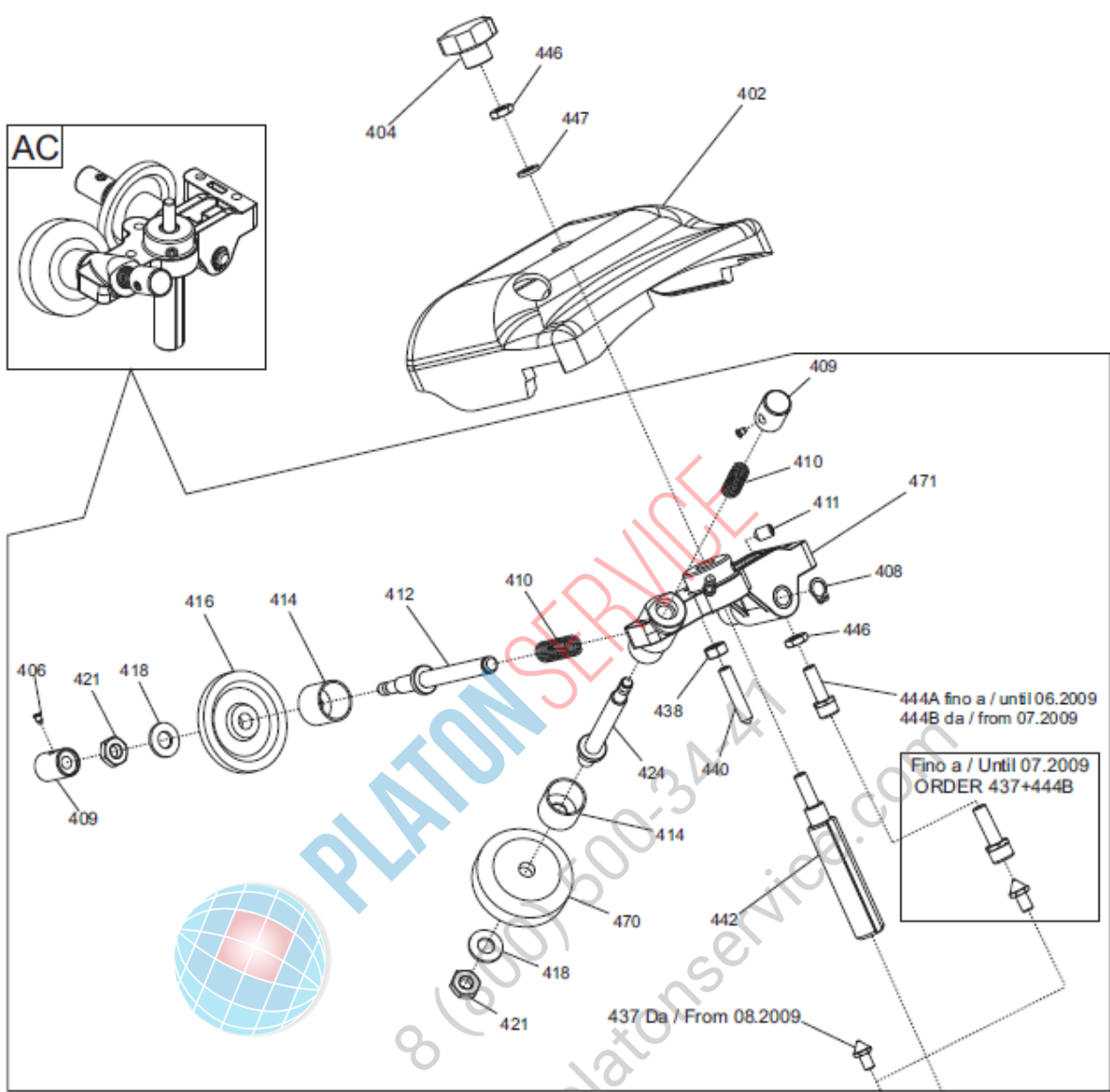

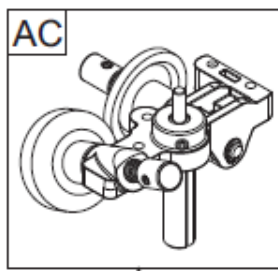

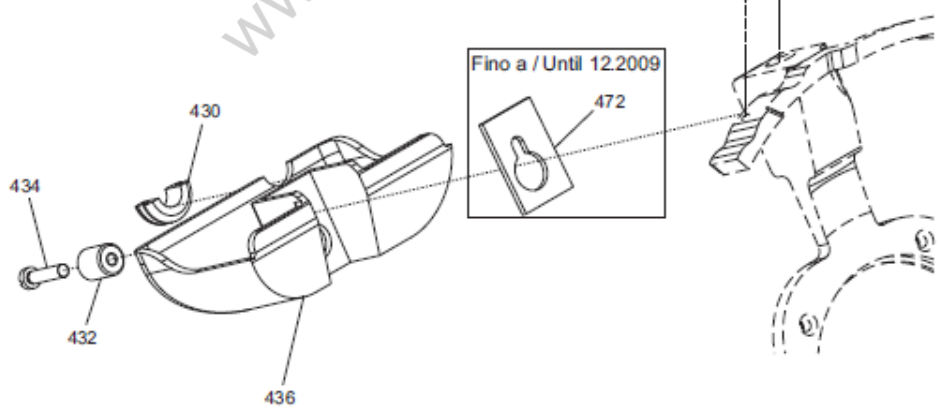

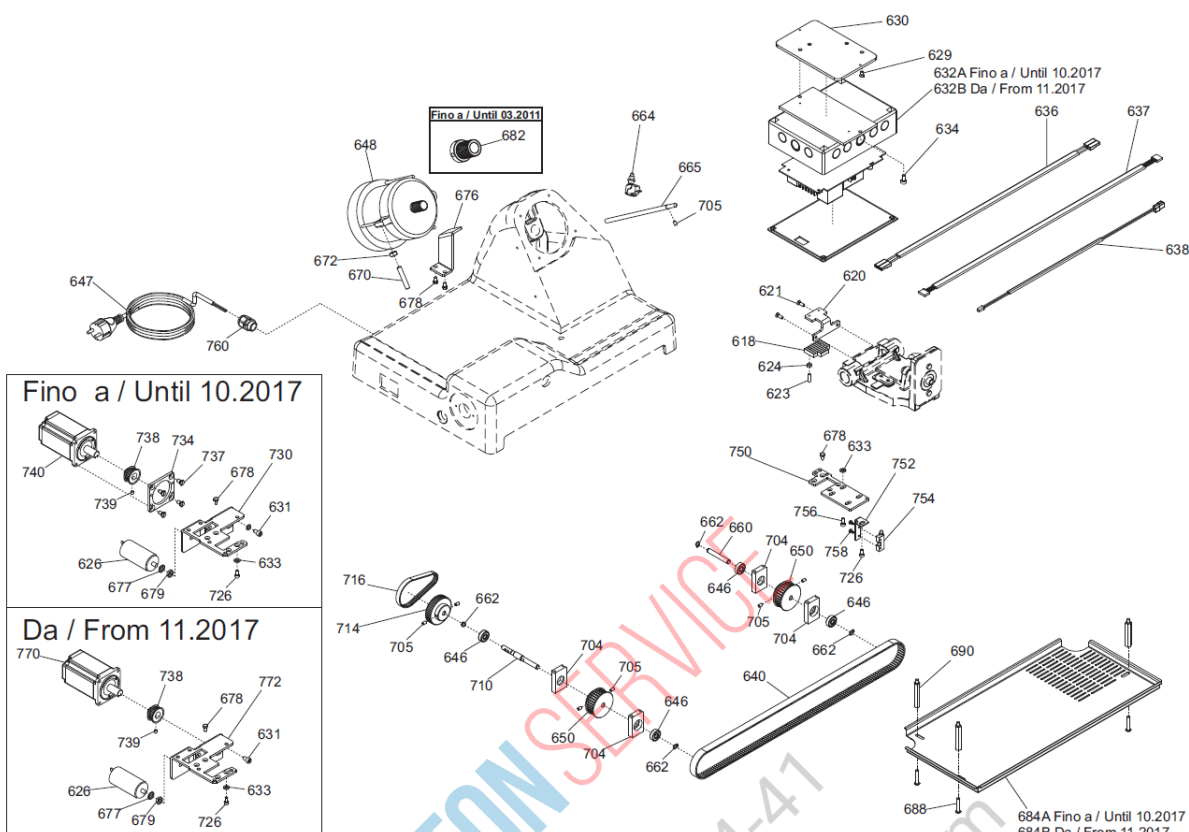













PLATON SERVICE
8 (800) 500-3424
www.platonservice.com





PLATON SERVICE
 8 (800) 500-34-41
www.platonservice.com

	02 ST	CASSA 300-330-350 PLD CERAM.		1903T0160	1
	02	CASSA 300-330-350 PLD OSS		19510160	1
	03	PARAC.PIEDINO D.30X20-M8X23	★	19560156	1
	03/4	PIEDINO 275:370 M8	★	19560202	1
	05	PIASTRINA PIEDINI PLD 300		19540660	1
	06 ST	INT.LAMA 300 PLD+MNT DAL 09 CERAM.		1903T0240	1
	06	INT.LAMA 330 PLD+MNT Y09 H.9 OSSID.		19510243	1
	08	POMELLO PARALAMA _LAV		19021110	5
	12	VITE TSP- DIN 963 M 5X14		IX2963005014	10
	13	VITE TSP- DIN 963 M 4X10		IX2963004010	20
	14	QUADRETTO PARALAMA 250-330		19530905	1
	15	ANELLO TENUTA 95X110X6 SC NBR		195621360	1
	16	LAMA 330 - 57/4/270 NAZ. F.ESTR.		18330574270F	1
	18 ST	AN.PR.LAMA 300 PLD CERAM.		1903T3060	1
	18	AN.PR.LAMA 330 PLD		19513061	1
	20	PERNO X ANELLO PLD 330 - CNV 250		19534076	1
	24	CINGH.PIAT.SG 300 TB2 380 X 10		19310207	1
	28	ANELLO PORTA MICRO 250-330		19540905	1
	29	VITE SENZA TESTA DIN 916 M 8X10 NE		NE0916008010	10
	34	MANOPOLA TIR.PAR. M8 5 LOB GRIGIA		19564023	1
	34 BL	MANOPOLA TIR.PAR.M8 5 LOB BLU		19564013	1
	36	PARAFETTA PLD-RFL LAMA 330		19531041	1
	37	VITE SENZA TESTA DIN 916 M 6X10 NE		NE0916006010	10
	39	VITE INOX PARAFETTA 300:385		19335011	5
	40 ST	VELA 300 PLD CERAM.		1903T0360	1
	40	VELA 330 PLD OSSIDATA		19510361	1
	41	PRIGIONIERO PARAF.LNR MNZ 250/385		19336052	5
	44	VITE BLOCC.VELA TQ 8 X 29 PLD 300		193350055	1

PLATON SERVICE
 (800) 500-34-41
 www.platonservice.com

	46	VITE SENZA TESTA DIN913 M8X10 P.PN	IX2913008010	10
	48	PERNO MOV.+SUPP.VELA IX.PLD	19530760	1
	50	VITE SENZA TESTA DIN913 M6X20 P.PN	IX2913006020	10
	52 ST	COP.SUP.VELA 300 PLD CERAM.	1903T2260	1
	52	COP.SUP.VELA 300 PLD OSS	19512260	1
	54	ANELLO RADIALE DIN 6799 M8	IX26799008	1
	56	MANOP.IX.COPERC.SUPP.VELA LNR	19335021	1
	62	GUARN. COPER.SUP.VELA PLD 300	19563060	1
	63	RONDELLA PIANA DIN 125 D 8	IX2125008	20
	64	MOVIMENTO VELA PLD 300 LAVORATO	19500150	1
	66	PIASTRINA MOV. 300-370 ZINCATA	19540609	1
	70	VITE TE DIN 933 M 6X12 T.F.	IX2933006012	20
	72	PRIGIONIERO M6 X 17 OTTONE MRR.300V	19337032	10
	73	DADO ES. DIN 934 M 6	IX2934006	20
	78	VITE TCEI DIN 912 M 6X30	IX2912006030	10
	80	VITE TCEI DIN 912 M 6X20	IX2912006020	10
	82	PRIGIONIERO 6 X 25 OTTONE	19337002	10
	84	MOLLA MOVIMENTO PLD 300	19390760	5
	85	TAPPO X MOVIMENTO CNV-PLD	19536040	1
	90	RULLINO MOVIMENTO PLD DAL 08	19336073.08	1
	94	VITE SENZA TESTA DIN 916 M 6X08 NE	NE0916006008	10
	96	RONDELLA ONDULATA 19	19342006	10
	97	TUBETTO OLIATORE 350-370	19553009	5
	98	RONDELLA PLEX MAN.NUM.300-370	19562150	1
	99	BOCCOLE AUTOLUBR.18.20.20	19324108	10
	100	DISTANZIALE MAN.GRAD.GDO PLAST.	19561258	1
	103	TARGHETTA OIL.S.	19420175	10
	106	GHIERA SUPP ANELLO MRR 250 SG	19534062	1
	108	RONDELLA F.LARGA DIN 9021 D 8X24	IX29021008024	10
	110	DADO ES. DIN 934 M 8	IX2934008	20
	111 IX	PULEG.PIAT.MONT.IX PLD 300	19700360X	1
	111	PULEG.PIAT.MONT.PLD 300	19700360	1
	112	CAMMA PLD CNV LAV.	19563560LV	1
	113 GR	MANOP.NUMER.PLD-MNT-CNV L.53 GRIGIA	19564035	1
	113 BL	MANOPOLA NUM. BLU PLD-MNT-CNV L.53	19564017.15	1
	114	TIRANTE PARALAMA SG 300-330	19530507	1
	122	TAPPO X FORO MOTORE PLD	19536075	1

202	PIAST. SGANCIO FILET.AFF.CE	19533200	1
204	PIAST. SGANCIO CARR. PLD 300 DAL 08	19533260.08	1
206	PUNTALE SGANCIO 300-385 CE	19565001	5
211	DADO ES. DIN 934 M 6	IX2934006	20
212+214	CARRELLO PLD 300 AUTOL. LAV.PFUS	19500560	1
214	BOCCOLA AUTOLUBR.22.25.30	19324106	5
218	VITE TCEI DIN 912 M 6X20	IX2912006020	10
220	PRIGIONIERO M8 OTTONE CARR.LNR 350	19337054	10
222	DADO ES. DIN 934 M 8	IX2934008	20
223	PERNO PER SGANC.300-350 MNT-PLD	19534036.10	1
224	MOLLA PER SGANCIO 300-370 CE	19390601	10
225	RONDELLA A SPESSORE CUSCINETTO	19346015	5
226	BUSSOLA FIL.X SGANC.300-330 CE	19534025	1
227	PERNO CUSCINETTO 250-330	19540805	1
228	GHIERA FILET.ESTER. 300-330 CE	19534030	1
232	PIASTRINA CARRELLO 300-330 CE	19533007	1
236	CUSCINETTO CARR. 6000 2RS R11	19320154	1
237	VITE TSP- DIN 963 M 5X25	IX2963005025	10
239	ANELLO NEODIMIO D.15 X 2 F.7	19419015	1
241	DADO ES. DIN 934 M 5	IX2934005	20
242	BARRA TONDA CARR.22X495 300-330	19530607	1
243	VITE TCEI DIN 912 M 8X20	IX2912008020	10
246	PARAC.CARRELLO D.25X25-M6X17 PARAB.	19560154	1
248	BARRA QUADRA 300-330 ZINCATA	19540107	1
250	VITE T.26 BARRA TONDA	19335002	1
252	PIASTRINA TEMPR. 300-330	19530807	1
254	MOLLA BARRA TONDA 300-330 SG CE	19390117	5
256	MAN. BLOCCA GAMBO M10 GRIGIA	19564022	1

256 BL	MANOPOLA BLOCCA GAMBO M10 BLU CE	19564011	1
257	VITE SENZA TESTA DIN913 M10X50 P.PN	IX2913010050	10
258	GAMBO PLD 300-330-350 OSSIDATO	19510660	1
259	BUSSOLA INOX GAMBO 300 SG-PLD	19534020	1
260	VITE BLOCC.VELA TQ 8 X 38 AF 350	19335007	1
261	BUSS.FRES FERMA MAN.300-370 CE	19534016	1
262	RONDELLA F.LARGA DIN 9021 D 8X24	IX29021008024	10
264A	PIATTO PLD NETTUNO 300 OSSIDATO	19510419	1
264B	PIATTO PLD NETTUNO 300 Y11 OSSIDATO	19510419.11	1
272	BLOCCH.SCORRIM.SPOND.NETTUNO GLL	19526065	1
274	GOMMINO PARAC.D.12 SG300 DAL 2001	19560103	10
275	VITE TSP- DIN 963 M 6X16	IX2963006016	10
276	ASTINA.SCORR.SPOND.NETT.PLD 300	19530424	1
279	PRIGIONIERO 6 X 25 OTTONE	19337002	10
280	MANOPOLA TIR.PAR.M6 5L MRR NERO	19562502	1
281A	FUNGHETTO MOVIMENTO D8,5XHT2	19563201	5
281B	PRIGIONIERO PLASTICA M6X30 GLL	19566864	10
282+284+336	SUPPORTO ASTA + TUBETTI NETT.Y11	19700171	1
283	VITE TSPEI DIN 7991 M 8X20	IX27991008020	10
284	BOCCOLE AUTOLUBR.14.16.12	19324104	10
285	DADO PLASTICA M6 GLL	19566866	10
288	VITE SVASATA PARAMANO GLL	19335064	1
290	RONDELLA PIANA DIN 125 D 8	IX2125008	20
292	DADO ANTIMANOMISSIONE	19363560	1
294	P.MANO POLIC. PIATTO PLD	★ 19562342	1
296B	ASTA BLOCCA PRODOT.NETT.GLL 350-385	19530422	1
296A	ASTA BLOCCA PRODOT.NETT.PLD 300	19530425	1
298	DISTANZ.IMPUGNATURA SPOND. GLL	19533964	1

300	BLOCCH.IMPUGN.SPONDINA NETTUNO GLL		19526064	1
310	MAN. A VOLANO PRESSAM GRIGIA	★	19564021	1
310 BL	MANOPOLA A VOLANO PRESSAM BLU		19564012	1
312B	ASTINA STAFFA PIAT.NETT.GLL 350-385		19530420	1
312A	ASTINA STAFFA PIAT.NETT.PLD 300		19530423	1
314	MOLLA ASTINA 12 NETTUNO GLL L=403		19390408	1
315	BLOCCH.DRITTO ASTINA NETT.PLD 300		19525073	1
316	BLOCCH.MAGG.PIATTO NETT.PLD 300 OSS		19525072	1
317	VITE SENZA TESTA DIN 916 M 5X06 NE		NE0916005006	10
319	VITE TE DIN 933 M 6X16 T.F.		IX2933006016	10
320	BLOCCH.IMPUG.LNR+VAS DAL 04		19525052	1
322	VITE SENZA TESTA DIN913 M10X45 P.PN		IX2913010045	10
326	TAPPO X PIATTO D.08 LNR BS2		19560124	10
327	VITE TE DIN 933 M 6X14 T.F.		IX2933006014	10
328 BL	MANIGLIA GAMBO BLU		19562808B	1
328 GR	MANIGLIA GAMBO GRIGIA		19562808G	1
329	BUSSOLA BLOCC.STAFFETTA NETTUNO GLL		19530865	1
331	STAFFETTA BLOCC.STAFFA NETT.GLL PAL		19530864P	1
332	MANIGLIA STAFFA NETTUNO GLL 350-385		19538864	1
335	ANELLO RASAMENTO NETT. 18X25 SP.1		19342530	10
336	BOCCOLE AUTOLUBR.12.14.12 DAL 01		19324102	10
337	ANELLO RASAMENTO NETT. 22X30 SP.0,5		19342532	10
338	PARACOLPO DISTACCO STAFFA NETT. GLL		19563220	1
340	STAFFA+TUBETTO PORTABRONZ.NETT.Y11		19700170	1
341	VITE TSP- DIN 963 M 5X60		IX2963005060	10
342	PARACOLPO STAFFA NETTUNO GLL		19563221	1

AC	ASS.CORPO AFFIL.+SMERIG.LNR 300-385		19800120	1
402 ST	CAPPOTT. 300-385 LNR CE CERAM.		1903T1252C	1
402	CAPPOTT. 300-385 LNR CE OSSIDATA		19511252C	1
404 RS	MANOP.CAPPOTT.ROSS.M6 6LOBI		19564005	1
404 BL	MANOPOLA TIR.PAR.M6 5L MRR BLU		19564016	1
404GR	MANOPOLA TIR.PAR.M6 5L MRR GRIGIA		19564029	1
404 NR	MANOPOLA TIR.PAR.M6 5L MRR NERO		19562502	1
406	VITE BLOC.PULSANTE AFF.250-370		19335025	10
408	ANELLI D ARRESTO DIN 471 D 08E		IX2471008	10
409	PULSANTE AFFILATOIO 330:370		19550208	1
410	MOLLA PERNO AFF.+SBAV. 300:385		19390309	10
411	VITE SENZA TESTA DIN 916 M 6X08 NE		NE0916006008	10
412	PERNO SBAVATURA 330:370		19540709	1
414	BICCHIERINO AFF. LNR		19540718	1
416	MOLA SB.350 D.50 H.8 F.8	★	19300209	1
418	RONDELLA PIANA DIN 125 D 8		IX2125008	20
421	DADO ES. DIN 439 M 8 BASSO		IX2439008	10
424	PERNO AFFILATURA 330:370		19540708	1
430	GOMMINO ANTIMBRANTE CAPP. LNR		19560152	1
432	MANOP.IX.VASCHETTA AFF. Y11 LNR		19335023.11	1
434	VITE TC- DIN 84 M 6X25		IX284006025	10
436 ST	VASC.AFF.300-385 LNR CERAM.		1903T1253C	1
436	VASC.AFF.300-385 LNR OSSIDATA		19511253C	1
437	VITE RISCONT. CONICA ANELLO DAL 09		19336055.09	1
438	DADO ES. DIN 934 M 6		IX2934006	20
440	VITE SENZA TESTA DIN914 M6X30 P.CN		IX2914006030	10
442	PERNO COL.AFFILATOIO FRESATO LNR		19540452.09	1
444A	CAPPUCCIO RISCONT.AFFIL. LNR		19336056	5
444B	CAPPUCCIO RISCONT.AFFIL. DAL 09		19336056.09	1
446	DADO ES. DIN 439 M 6 BASSO		IX2439006	10
447	RONDELLA PIANA DIN 125 D 6		IX2125006	10
470	MOLA AF.330-385 D.48 H.15 F.8 Y10	★	19300108C.10	1
471	CORPO AF.LNR PRESSOF. LAV		19021352.11	1
472	PIAST. VASCHETTA AFFIL. PLD 300		19533360	1

618	PETTINE TRASCIN.CARRELLO GLL 5M15	19500474	1
620	PIASTRINA PETTINE BLOCCATO GLL AUT.	19532584	1
621	VITE TSP- DIN 963 M 5X14	IX2963005014	10
623	VITE SENZA TESTA DIN913 M5X18 P.PN	IX2913005018	10
624	DADO ES. DIN 934 M 5	IX2934005	20
626	CONDENSATORE SG300 10UF CODOLO M8	19410307	1
629	VITE TSP- DIN 963 M 5X10	IX2963005010	20
630	PIASTRA SUPP.SCATOLA ELETT. PLD	19027660	1
631	VITE TCEI DIN 912 M 6X10	IX2912006010	10
632A	SCHEDA + SCATOLA AZIONAM.AUTOM. PLD	19413960	1
632B	SCHEDA+SCATOLA AZION.AUTOM.Y17 PLD	19413960.17	1
633	RONDELLA PIANA DIN 125 D 6	IX2125006	10
634	VITE TCEI DIN 912 M 6X12	IX2912006012	10
636	CAVO MICRO 220-250 NO NORM NO CAS	19410701	1
637	CAVETTO ALIM. PULSANT. GLL AUT.	19410729	1
638	CAVET.PROLUNGA MICRO MAGN.GLL AUT	19410726	1
640	CINGH.DENT.RINV. GLL HTD1175-5M 15	19310365	1
646	CUSCINETTO AUTOMAT.GLL 608 2RS	19320262	5
647	CAVO ALIM.COMP. MN SUKO UNIFI	19410502	1
648	MOTORE 300 MN C.PIAT.Y11 PLD 230-50	19400107.11	1
650	PUL.DENT.RINV. PLD 300 HTD LAV.	19500460L	1
660	PERNO PULEGGIA CONDOTTA GLL AUT	19538064	1
662	ANELLI D ARRESTO DIN 471 D 08E	IX2471008	10
664	MICRO INTERRUTT.MN X AFFETTATR	19410201	1
665	PERNO MOTORE PLD 300	19540560	1
670	VITE SENZA TESTA DIN913 M8X45 P.PN	IX2913008045	5
672	DADO ES. DIN 934 M 8	IX2934008	20
676	STAFFA TIR. MOTORE PLD 300	19540360	1

676	STAFFA TIR. MOTORE PLD 300	19540360	1
677	RONDELLA DENTEL. DIN 6798-A D 8E	IX26798A008	20
678	VITE TSP- DIN 963 M 5X14	IX2963005014	10
679	DADO ES. DIN 439 M 8 BASSO	IX2439008	10
682	PULEGGIA X MOTORE 300-330	19541201	1
684A	PROTEZIONE INF. PLD 300 AUT + INGR.	19531660	1
684B	PROTEZIONE INF.PLD 300 AUT+INGR.Y17	19531660.17	1
688	VITE TBEI ISO 7380 M 6X30	IX27380006030	10
690	PERNO ESAG.SUP. COPER. LNR DAL 07	19540752.07	1
704	BLOCCHETTO SUPP. CUSC. AUT PLD 300	19521460	1
705	VITE SENZA TESTA DIN 916 M 5X08 NE	NE0916005008	10
710	PERNO PULEGG.MOTRICE GLL AUT	19538065	1
714	PUL.DENT.CONDOTTA PLD HTD LAV.	19500465L	1
716	CINGH.DENT.MOTRIC.PLD HTD255-3M 09	19310363	1
726	VITE TCEI DIN 912 M 5X10	IX2912005010	20
730	PIASTRA SUPP.MOT PLD AUT 300	19532560	1
734	PIAST.REGOL.ALTEZZA MOT.AUT.PLD 300	19532563	1
737	VITE TSP- DIN 963 M 6X12	IX2963006012	10
738	PUL.DENT.MOTRICE PL-GL HTD 28D LAV.	19500464L	1
739	VITE SENZA TESTA DIN 916 M 5X06 NE	NE0916005006	10
740	MOTORE AUTOMAT.PLD-GLL R7M-A200W	19401960	1
750	PIASTRA SUPP.RINVIO PLD AUT 300	19532561	1
752	PIASTRINA SUPPORTO SENSORE GLL AUT	19532570	1
754	MICRO MAGNETICO TM	IV5820000	1
756	VITE TCEI DIN 912 M 5X12	IX2912005012	20
758	VITE AUTOF.TC+ DIN 7981 D 3,5X9,5	IX279813,5009,5	20
760	PRESSACAPO PG 11 FIL.LUNGO	19410806	1
761	GHIERA PRESSACAPO PG 11	19410807	10
770	MOTORE AUTOM.PLD-GLL BCH2LD0233CA5C	19401960.17	1
772	PIASTRA SUPP.MOT Y17 PLD AUT	19532560.17	1